

單相 110V

機種		出力 (w)	起動轉鉅 (g.cm)	額定轉鉅 (g.cm)	額定電流 (A)	電容量 (uF)	適用減速機		最大容許負載 (kg.cm)
圓軸	齒軸								
2IK6RA-A	2IK6RGN-A	6	380	250~330	0.24	2.5	2GN□	2GN□K	25
3IK15RA-A	3IK15RGN-A	15	750	300~910	0.56	4	3GN□	3GN□K	50
4IK25RA-A	4IK25RGN-A	25	1300	450~1400	1.0	8	4GN□	4GN□K	80
5IK40RA-A	5IK40RGN-A	40	2300	600~2500	1.5	14	5GN□	5GN□K	100
5IK60RA-AF	5IK60RGN-AF	60	4200	1200~3700	2.4	16	5GN□	5GN□K	100
	5IK60RGU-AF	60	4200	1200~3700	2.4	16	—	5GU□K	150
5IK90RA-AF	5IK90RGU-AF	90	5500	2500~5500	2.9	25	—	5GU□K	200
5IK120RA-AF	5IK120RGU-AF	120	6500	2500~6500	4	25	—	5GU□K	200

註：頻率(HZ)50/60，極數(P)4，轉速(rpm)90~1350/1750，額定時間(min)連續。

單相 220V

機種		出力 (w)	起動轉鉅 (g.cm)	額定轉鉅 (g.cm)	額定電流 (A)	電容量 (uF)	適用減速機		最大容許負載 (kg.cm)
圓軸	齒軸								
2IK6RA-C	2IK6RGN-C	6	380	250~330	0.12	0.8	2GN□	2GN□K	25
3IK15RA-C	3IK15RGN-C	15	750	300~910	0.28	1.2	3GN□	3GN□K	50
4IK25RA-C	4IK25RGN-C	25	1300	450~1400	0.5	1.5	4GN□	4GN□K	80
5IK40RA-C	5IK40RGN-C	40	2300	600~2500	0.8	3	5GN□	5GN□K	100
5IK60RA-CF	5IK60RGN-CF	60	4200	1200~3700	1.2	3.5	5GN□	5GN□K	100
	5IK60RGU-CF	60	4200	1200~3700	1.2	3.5	—	5GU□K	150
5IK90RA-CF	5IK90RGU-CF	90	5500	2500~5500	1.5	5	—	5GU□K	200
5IK120RA-CF	5IK120RGU-CF	120	6500	2500~6500	1.8	6	—	5GU□K	200
5IK150RA-CF	5IK150RGU-CF	150	6700	3000~6700	2.4	6/8	—	5GU□K	200
5IK180RA-CF	5IK180RGU-CF	180	7000	4500~7000	3	8/10	—	5GU□K	200

註：頻率(HZ)50/60，極數(P)4，轉速(rpm)90~1350/1750，額定時間(min)連續。



5IK60RA-CF



5IK40RGN-C

5GN40B

單相 110V

機 種		出力 (w)	起動轉矩 (g.cm)	額定轉矩 (g.cm)	額定電流 (A)	電容量 (uF)	適用減速機		最大容許負載 (kg.cm)
圓 軸	齒 軸								
2RK6RA-A	2RK6RGN-A	6	390	310~320	0.23	2.5	2GN□	2GN□K	25
3RK15RA-A	3RK15RGN-A	15	820	470~1000	0.38	4	3GN□	3GN□K	50
4RK25RA-A	4RK25RGN-A	25	2100	900~1600	0.58	8	4GN□	4GN□K	80
5RK40RA-A	5RK40RGN-A	40	2400	1000~2500	0.9	14	5GN□	5GN□K	100
5RK60RA-AF	5RK60RGN-AF	60	4700	1200~3700	1.5	14	5GN□	5GN□K	100
	5RK60RGU-AF	60	4700	1200~3700	1.5	16	—	5GU□K	150
5RK90RA-AF	5RK90RGU-AF	90	5800	2500~5500	2.0	25	—	5GU□K	200

註：頻率(HZ)50/60，極數(P)4，轉速(rpm)90~1350/1750，額定時間(min)30。

單相 220V

機 種		出力 (w)	起動轉矩 (g.cm)	額定轉矩 (g.cm)	額定電流 (A)	電容量 (uF)	適用減速機		最大容許負載 (kg.cm)
圓 軸	齒 軸								
2RK6RA-C	2RK6RGN-C	6	390	310~320	0.12	0.8	2GN□	2GN□K	25
3RK15RA-C	3RK15RGN-C	15	820	470~1000	0.19	1.2	3GN□	3GN□K	50
4RK25RA-C	4RK25RGN-C	25	2100	900~1600	0.29	1.5	4GN□	4GN□K	80
5RK40RA-C	5RK40RGN-C	40	2400	1000~2500	0.45	3	5GN□	5GN□K	100
5RK60RA-CF	5RK60RGN-CF	60	4700	1200~3700	0.8	3.5	5GN□	5GN□K	100
	5RK60RGU-CF	60	4700	1200~3700	0.8	3.5	—	5GU□K	150
5RK90RA-CF	5RK90RGU-CF	90	5800	2500~5500	1.0	5	—	5GU□K	200

註：①頻率(HZ)50/60，極數(P)4，轉速(rpm)90~1350/1750，額定時間(min)30。②120W~150W特殊定做



5IK60RA-CF



5RK40RGN-C

5GN40B

US51 US52 配線圖
UX51 UX52

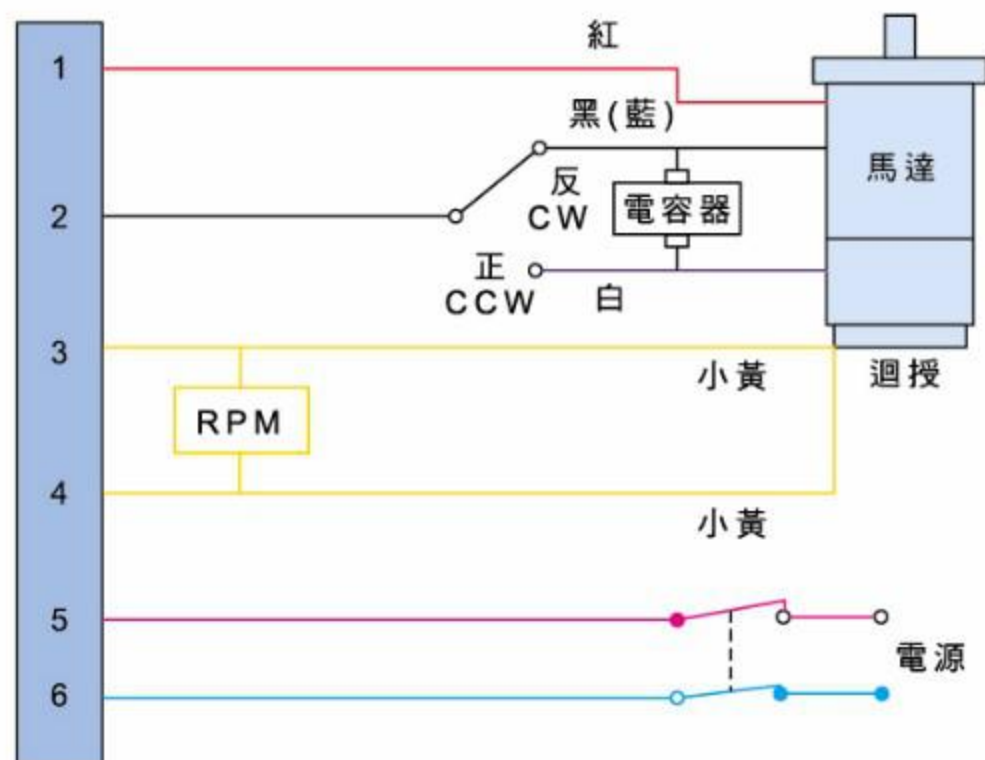

SS11 SS22 配線圖

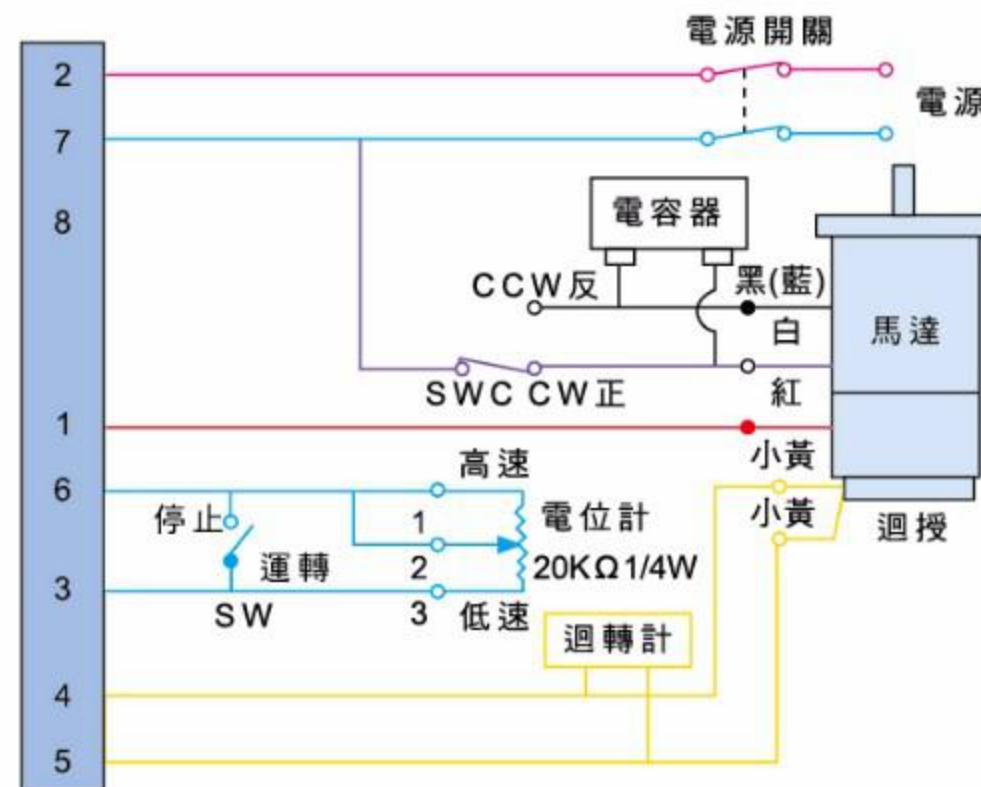

SB31-IN SB32-IN 配線圖

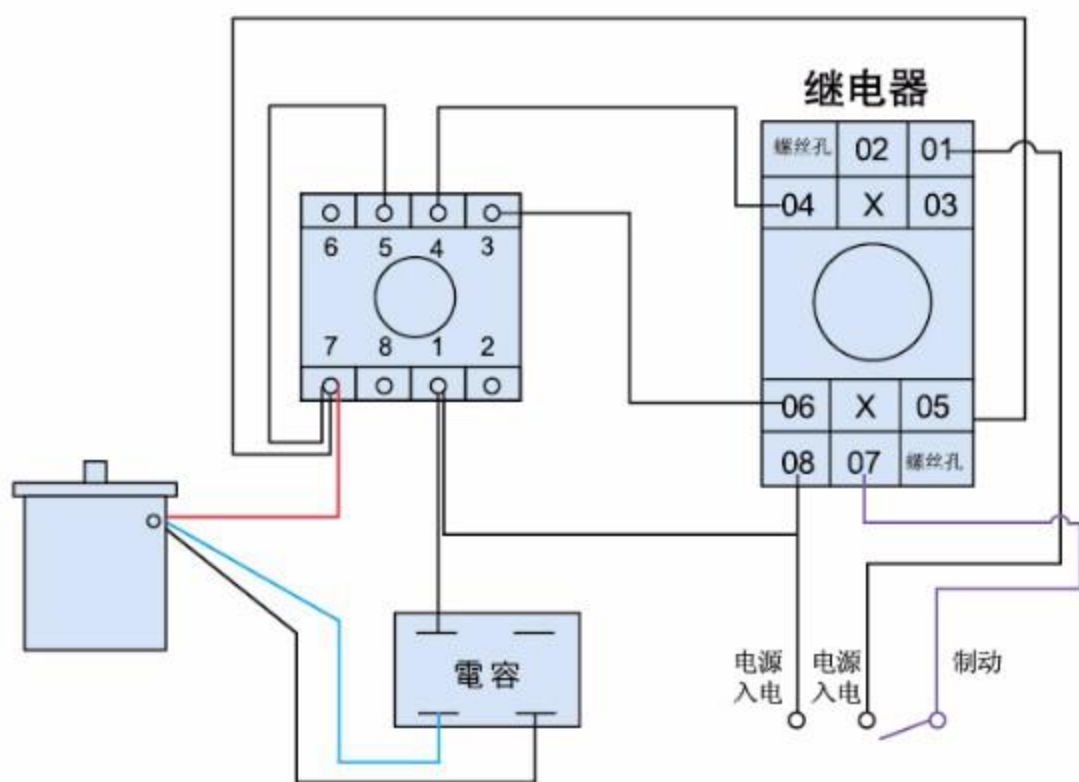

SS31 HR SS32 HR 配線圖

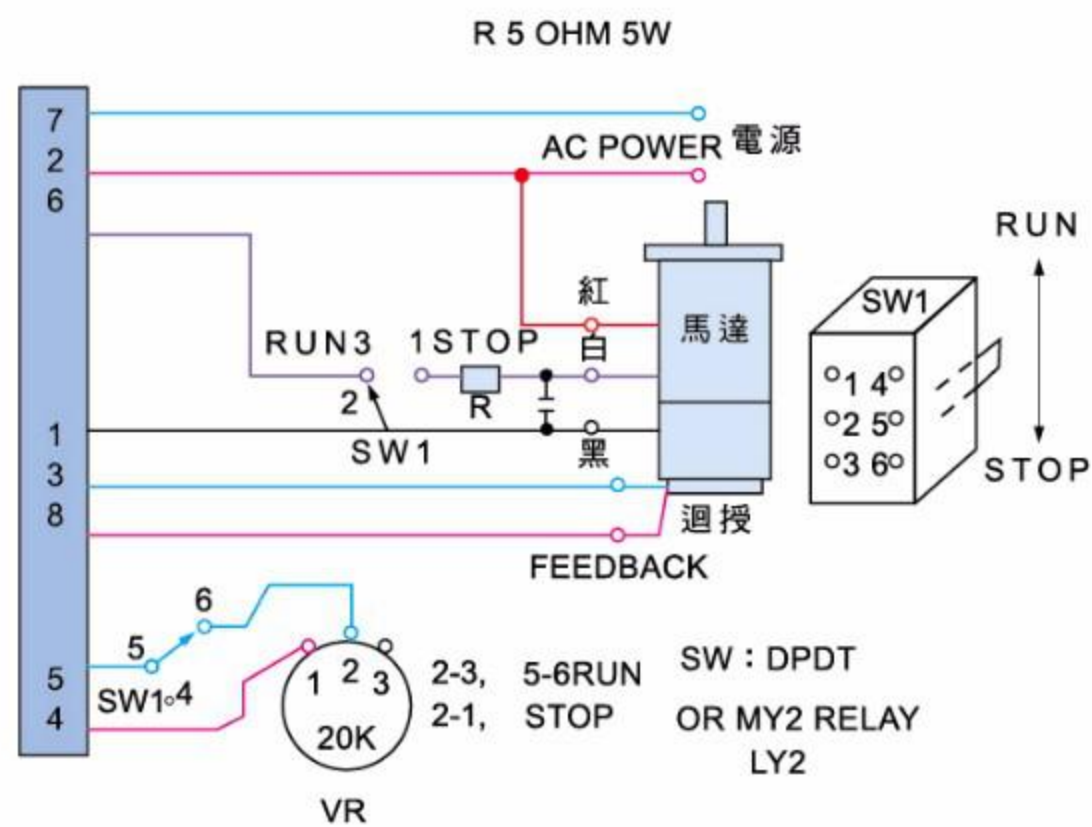

馬達品名 / 尺寸圖 (括弧內數字為螺旋齒軸外型圖)

馬達品名

2IK6RA-A
2IK6RA-C
2IK6RGN-A
2IK6RGN-C
2RK6RA-A
2RK6RA-C
2RK6RGN-A
2RK6RGN-C

GN 單位: mm

模數: 0.5
壓力角: 20°
螺旋角: 25°
齒數: 8
外徑: $\phi 5.5$
重量: 0.7kg

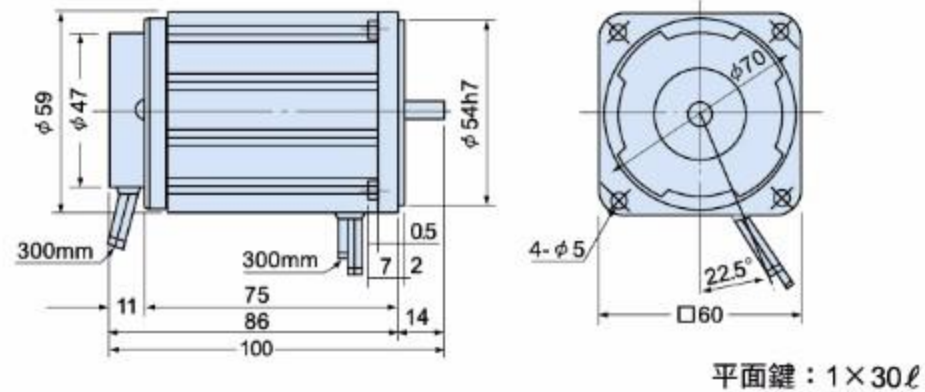

馬達品名

3IK15RA-A
3IK15RA-C
3IK15RGN-A
3IK15RGN-C
3RK15RA-A
3RK15RA-C
3RK15RGN-A
3RK15RGN-C

GN 單位: mm

模數: 0.5
壓力角: 20°
螺旋角: 25°
齒數: 10
外徑: $\phi 6.6$
重量: 1.1kg

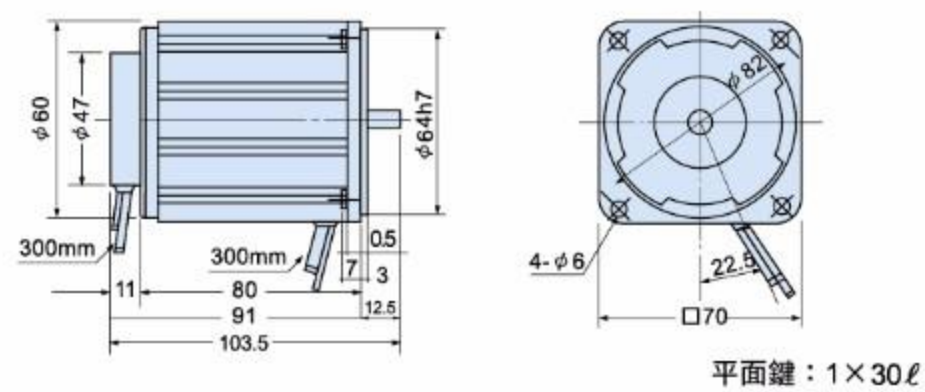

馬達品名

4IK25RA-A
4IK25RA-C
4IK25RGN-A
4IK25RGN-C
4RK25RA-A
4RK25RA-C
4RK25RGN-A
4RK25RGN-C

GN 單位: mm

模數: 0.6
壓力角: 20°
螺旋角: 25°
齒數: 9
外徑: $\phi 7.9$
重量: 1.5kg

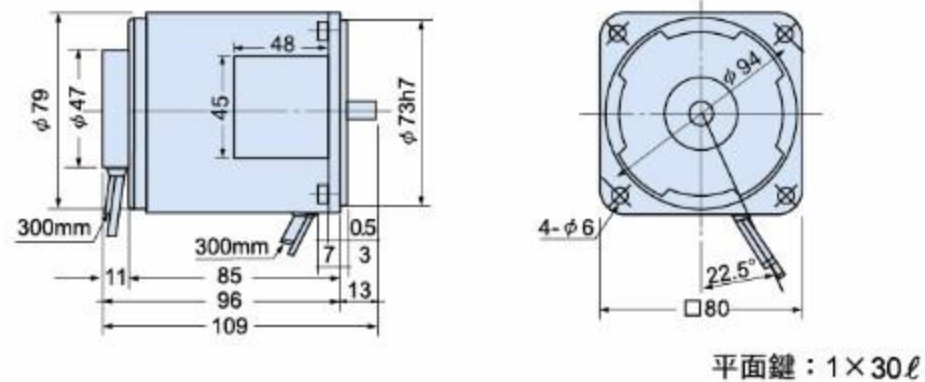

齒輪品名 / 尺寸圖

齒輪品名

2GN□
2GN□K

GN 單位: mm

2GN3-20 L=31.6
2GN25-180 L=41.8
平面鍵: 1×12ℓ
重量: 0.4kg

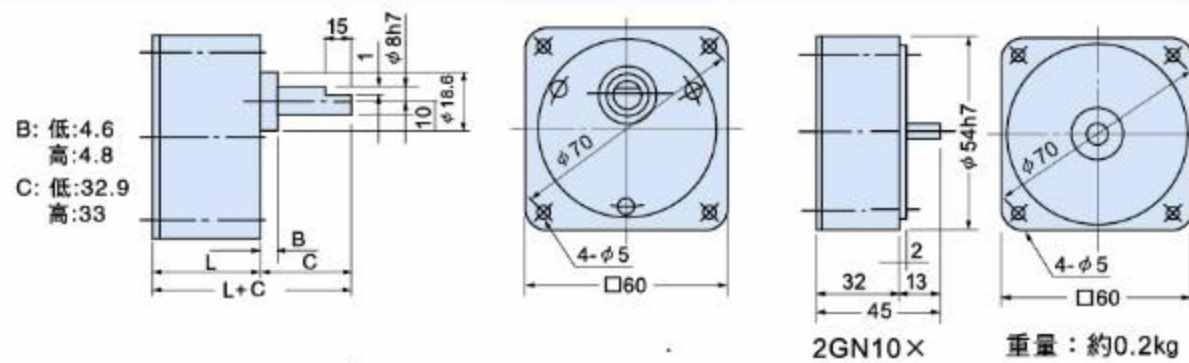

齒輪品名

3GN□
3GN□K

GN 單位: mm

3GN3-20 L=31.6
方鍵: 4×4×20ℓ
3GN25-180 L=41.8
方鍵: 4×4×25ℓ
重量: 約0.55kg

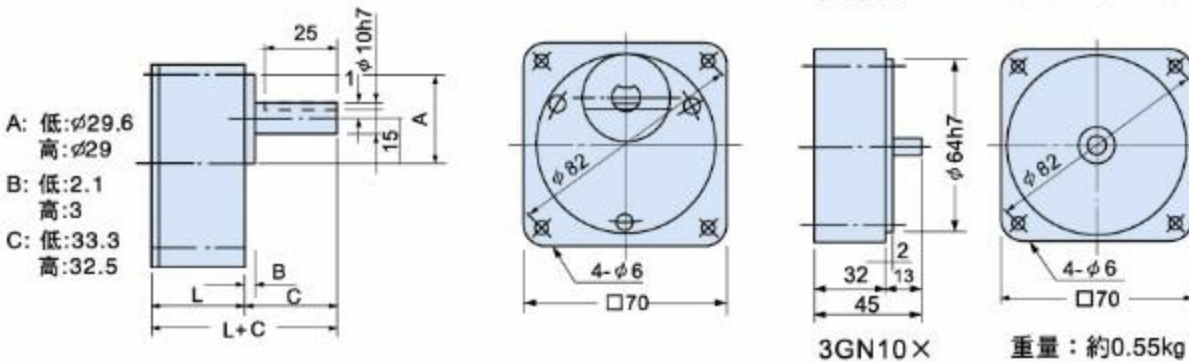

齒輪品名

4GN□
4GN□K

GN 單位: mm

4GN3-18 L=31.6
4GN20-180 L=45.1
方鍵: 4×4×25ℓ
重量: 約0.65kg

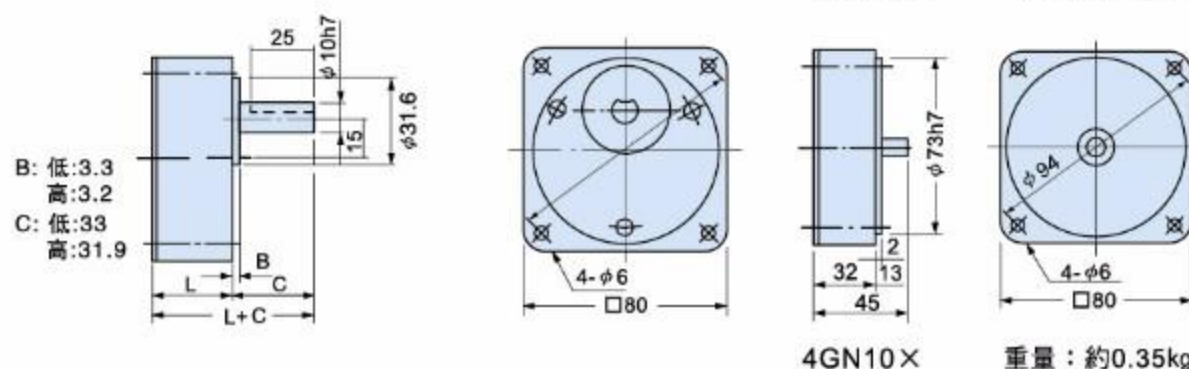

馬達品名 / 尺寸圖 (括弧內數字為螺旋齒軸外型圖)

馬達品名

5IK40RA-A
5IK40RA-C
5IK40RGN-A
5IK40RGN-C
5RK40RA-A
5RK40RA-C
5RK40RGN-A
5RK40RGN-C

GN 單位: mm

模數: 0.6
壓力角: 20°
螺旋角: 25°
齒數: 11
外徑: $\phi 8.9$
重量: 2.5kg

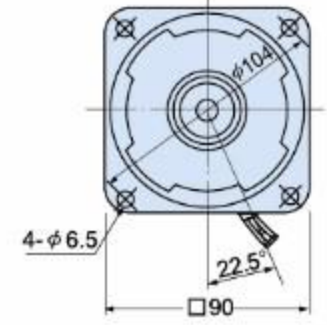
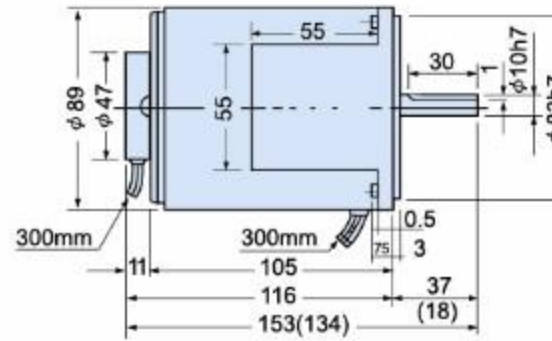

馬達品名

5IK60RA-AF
5IK60RA-CF
5IK60RGN-AF
5IK60RGN-CF
5IK60RGU-AF
5IK60RGU-CF
5RK60RA-AF

5RK60RA-CF
5RK60RGN-AF
5RK60RGN-CF
5RK60RGU-AF
5RK60RGU-CF

GN 單位: mm

模數: 0.6
壓力角: 20°
螺旋角: 25°
齒數: 11
外徑: $\phi 8.9$
重量: 2.7kg

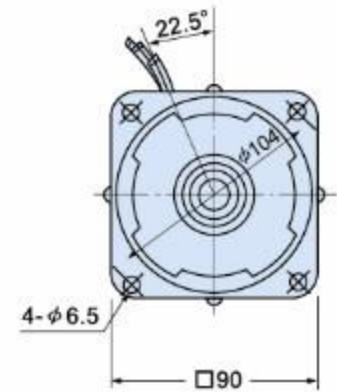
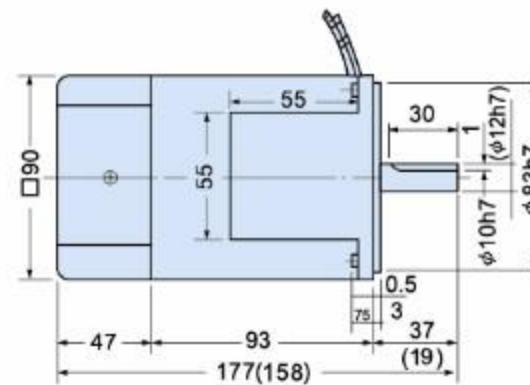

馬達品名

5IK90RA-AF
5IK90RA-CF
5IK90RGU-AF
5IK90RGU-CF
5IK120GU-AF
5IK120RGU-CF

GU 單位: mm

模數: 0.8
壓力角: 20°
螺旋角: 25°
齒數: 11
外徑: $\phi 11.8$
重量: 3.2kg

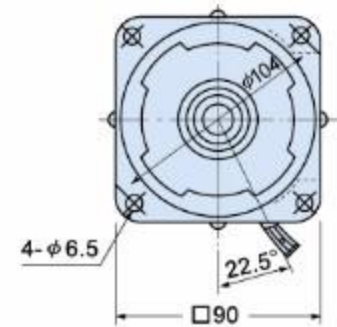
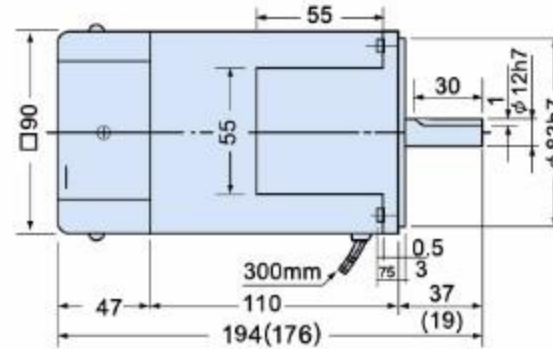

馬達品名

52K 180RA-CF
52K 180RGU-CF

GU 單位: mm

模數: 0.8
壓力角: 20°
螺旋角: 25°
齒數: 11
外徑: $\phi 11.8$
重量: 3.4kg

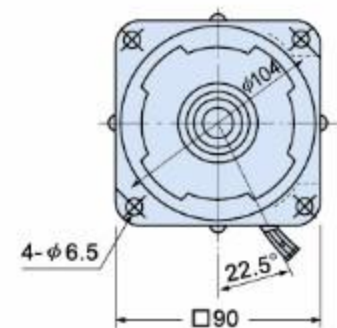
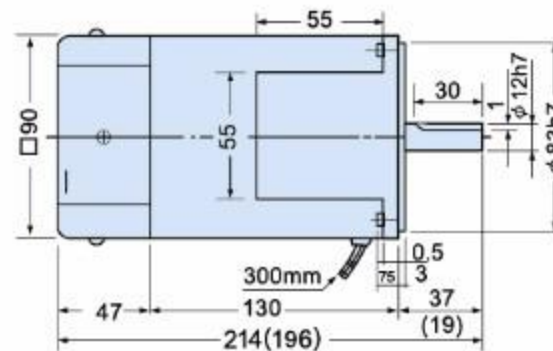

齒輪品名 / 尺寸圖

齒輪品名

5GN□
5GN□K

GN 單位: mm

5GN3-20 L = 39.7低
5GN25-180 L = 59.7高
平面鍵: 4×4×25 ℓ
重量: 約1.5kg

A: 低: 33.7
高: 32.7
B: 低: 3.3
高: 3.5
C: 低: 33
高: 32.9

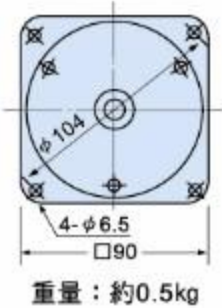
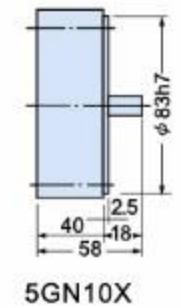
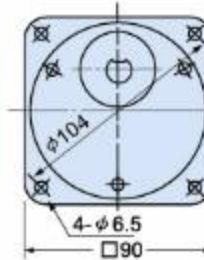
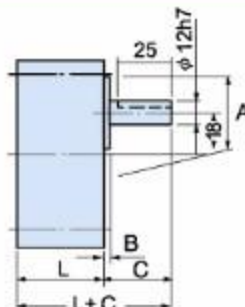

齒輪品名

5GU□K

GN 單位: mm

方鍵: 5×5×25 ℓ
重量: 約1.5kg

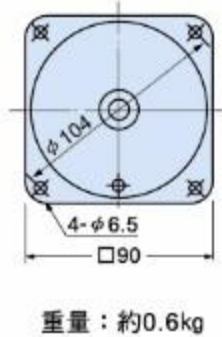
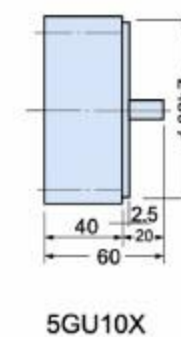
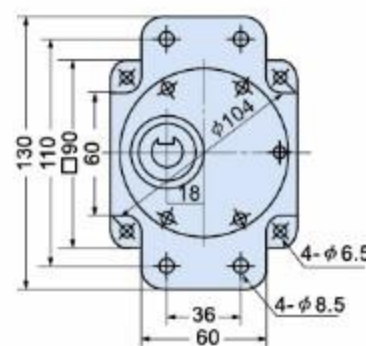
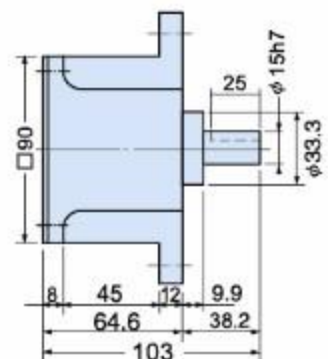

機種		出力	電壓	起動轉矩	額定轉矩	額定電流	電容量 (uF)	適用減速機		最大容許負載
圓軸	齒軸									
2RK6A-AM	2RK6GN-AM	6	1 φ 110	400	400	0.3	2.5	2GN□	2GN□K	25
2RK6A-CM	2RK6GN-CM	6	1 φ 220	400	400	0.2	0.8	2GN□	2GN□K	25
3RK15A-AM	3RK15GN-AM	15	1 φ 110	850	1000	0.45	4	3GN□	3GN□K	50
3RK15A-CM	3RK15GN-CM	15	1 φ 220	850	1000	0.25	1.2	3GN□	3GN□K	50
4RK25A-AM	4RK25GN-AM	25	1 φ 110	1500	1000	0.58	8	4GN□	4GN□K	80
4RK25A-CM	4RK25GN-CM	25	1 φ 220	1500	1500	0.29	1.5	4GN□	4GN□K	80
4RK25A-SM	4RK25GN-SM	25	3 φ 220	5000	1500	0.2	—	4GN□	4GN□K	80
5RK40A-AM	5RK40GN-AM	40	1 φ 110	2600	1500	0.9	14	5GN□	5GN□K	100
5RK40A-CM	5RK40GN-CM	40	1 φ 220	2600	3000	0.45	3	5GN□	5GN□K	100
5RK40A-SM	5RK40GN-SM	40	3 φ 220	6500	2600	0.31	—	5GN□	5GN□K	100
5RK60A-AM	5RK60GN-AM	60	1 φ 110	3000	3800	1.4	16	5GN□	5GN□K	100
5RK60A-CM	5RK60GN-CM	60	1 φ 220	3000	3800	0.7	3.5	5GN□	5GN□K	100
5RK60A-SM	5RK60GN-SM	60	3 φ 220	5000	3800	0.6	—	5GN□	5GN□K	100
—	5RK60GN-AM	60	1 φ 110	3000	3800	1.4	16	—	5GN□K	150
—	5RK60GU-CM	60	1 φ 220	3000	3800	0.7	3.5	—	5GU□K	150
—	5RK60GU-SM	60	3 φ 220	5000	3800	0.6	—	—	5GU□K	200
5RK90A-AM	5RK90GU-AM	90	1 φ 110	4500	5700	2.0	25	—	5GU□K	200
5RK90A-CM	5RK90GU-CM	90	1 φ 220	4500	5700	1.0	5	—	5GU□K	200
5RK90A-SM	5RK90GU-SM	90	3 φ 220	7000	5700	0.8	—	—	5GU□K	200

註：①頻率(HZ)50/60，極數(P)4，轉速(rpm)1450/1750，額定時間(min)連續。②120W~180W特殊定做

單相馬達接線圖

注：用于單一方向運轉接線法

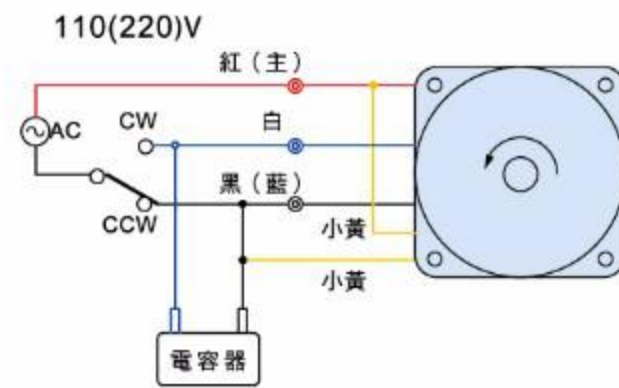
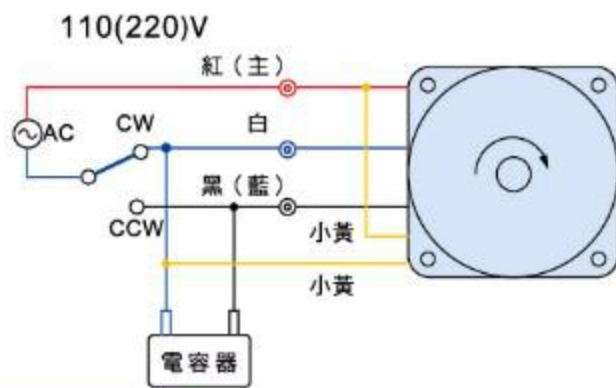

三相馬達接線圖

3φ × 380 × 50/60HZ

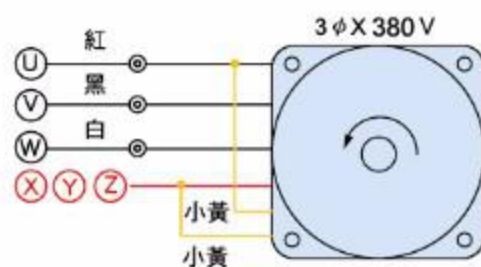
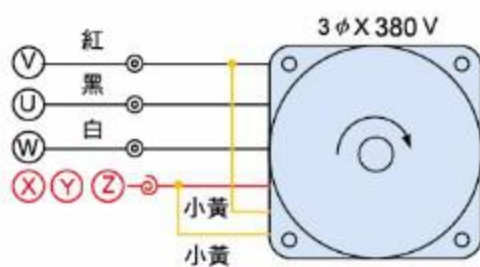

備注：⓪ Ⓧ Ⓦ 三綫為黑色綫
ⓧ Ⓨ Ⓩ 三綫為紅色綫



5IK60A-CMF